

CR2016

■ Dimensions(mm)

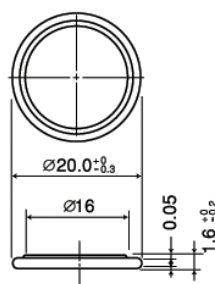

Mass 1.6g

■ Specification

Nominal voltage(V)	3
Nominal capacity(mAh)	90
Continuous drain(mA)	0.1
Operating temperature(°C)	-30 ~ +60

■ Temperature Characteristics

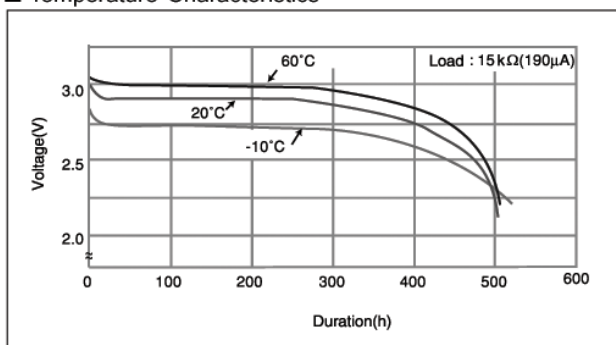

■ Operating voltage vs. load resistance(voltage at 50% discharge depth)

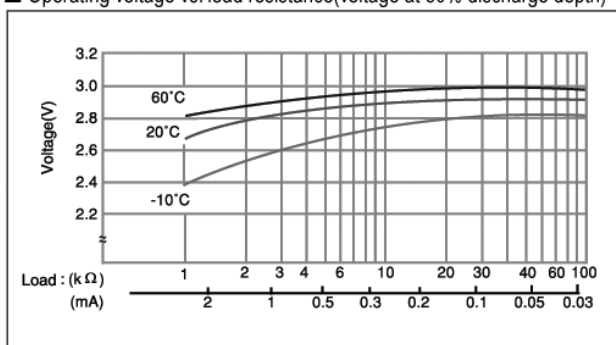

■ Capacity vs. load resistance

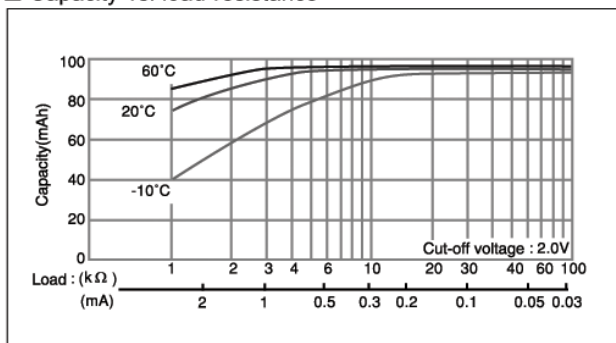
**CR2025**

■ Dimensions(mm)

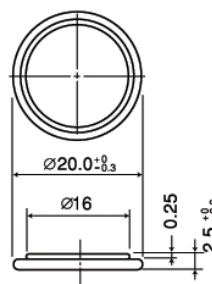

Mass 2.3g

■ Specification

Nominal voltage(V)	3
Nominal capacity(mAh)	165
Continuous drain(mA)	0.2
Operating temperature(°C)	-30 ~ +60

■ Temperature Characteristics

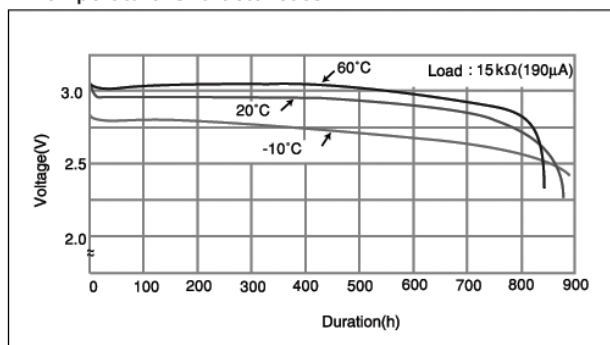

■ Operating voltage vs. load resistance(voltage at 50% discharge depth)

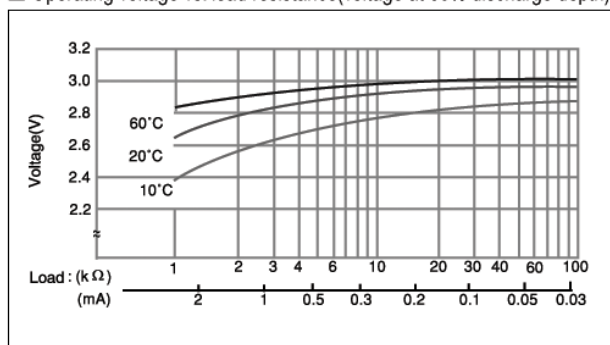

■ Capacity vs. load resistance

